



PORTO LAGO

APARTAMENT

NR **220**



Działka Nr 168/1
Serock

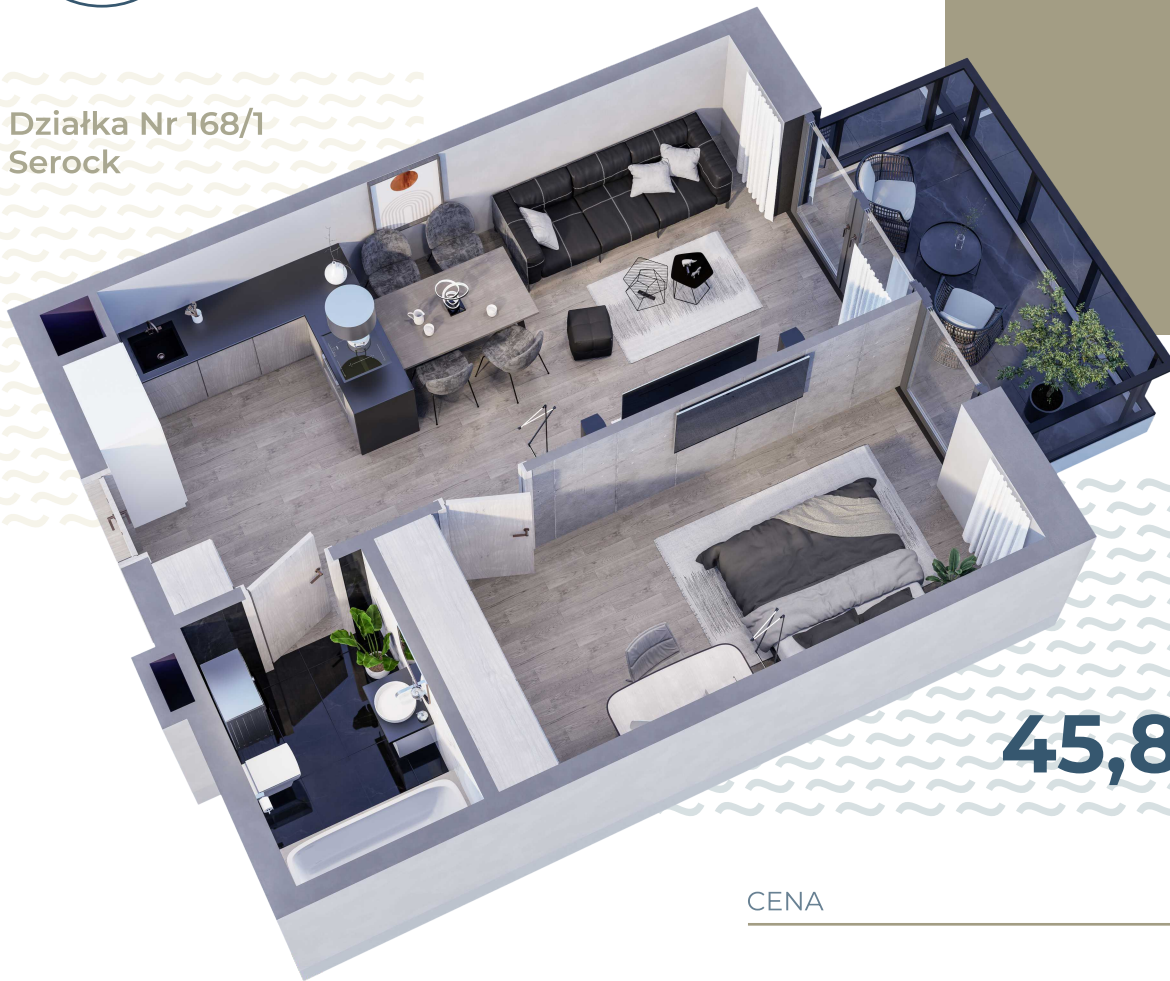

45,85 m²

CENA

BUDYNEK 1 KLATKA B

- | | |
|------------------------------|----------------------------|
| 1. Pokój z aneksem kuchennym | 23,08 m² |
| 2. Pokój | 14,86 m² |
| 3. Hol | 3,09 m² |
| 4. Łazienka | 4,82 m² |

45,85 m²

PIĘTRO 1

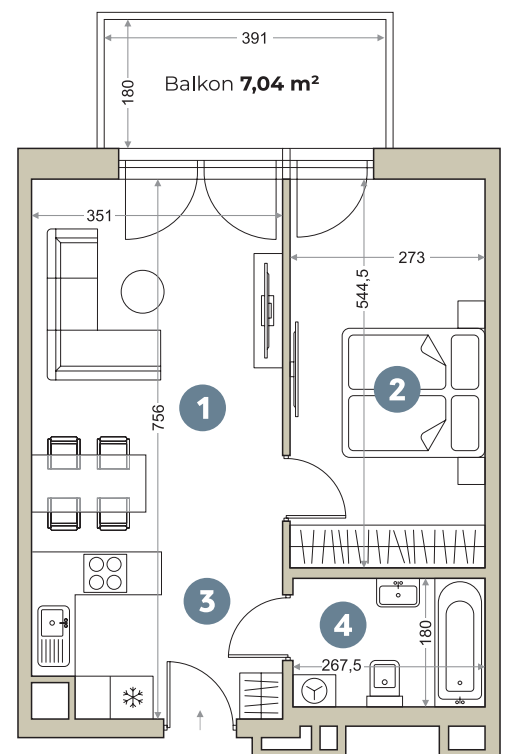



PORTO LAGO

