



# PORTO LAGO

APARTAMENT  
NR **218**



Działka Nr 168/1  
Serock



## 47,86 m<sup>2</sup>

CENA

### BUDYNEK 1 KLATKA B

- |                              |                            |
|------------------------------|----------------------------|
| 1. Pokój z aneksem kuchennym | <b>28,44 m<sup>2</sup></b> |
| 2. Pokój                     | <b>11,77 m<sup>2</sup></b> |
| 4. Hol                       | <b>3,40 m<sup>2</sup></b>  |
| 5. Łazienka                  | <b>4,25 m<sup>2</sup></b>  |

**47,86 m<sup>2</sup>**

### PIĘTRO 1

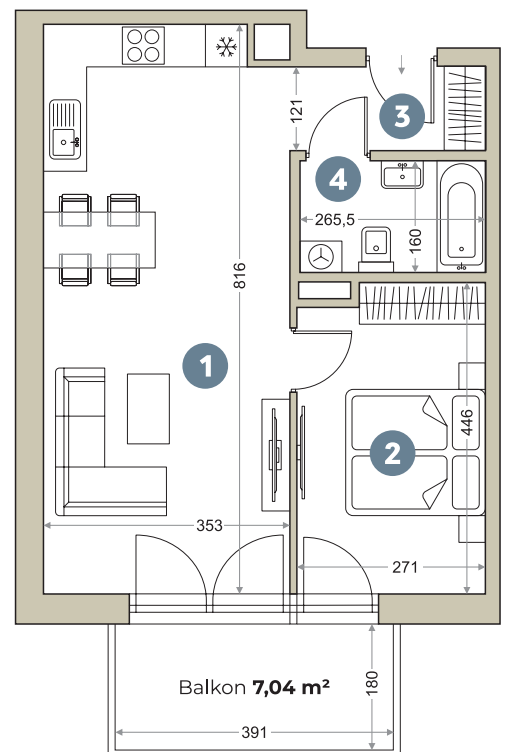



PORTO LAGO

