



PORTO LAGO

APARTAMENT
NR 217



Działka Nr 168/1
Serock

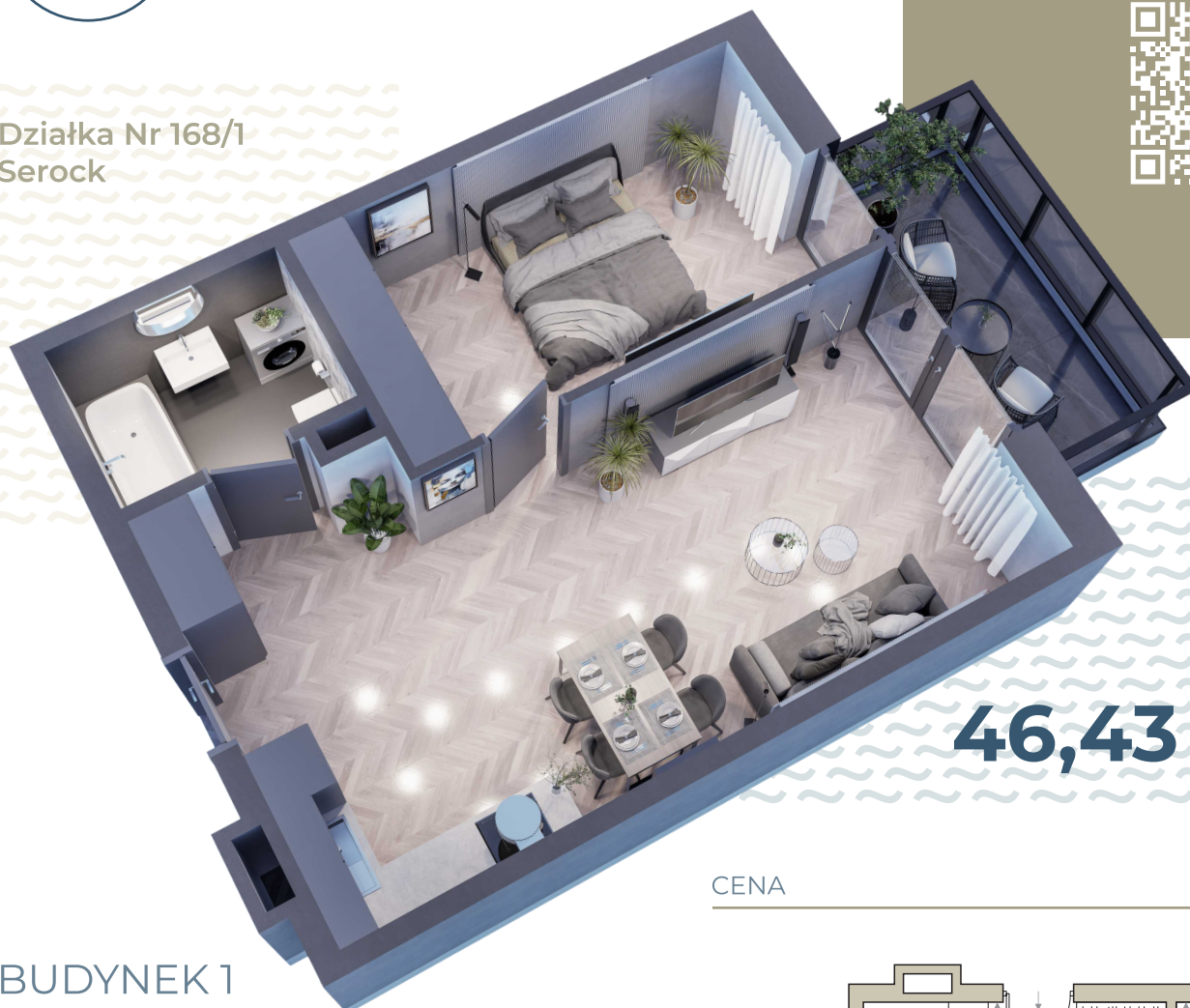

46,43 m²

CENA

BUDYNEK 1 KLATKA B

- | | |
|------------------------------|----------------------|
| 1. Pokój z aneksem kuchennym | 23,83 m ² |
| 2. Pokój | 13,66 m ² |
| 3. Hol | 4,33 m ² |
| 4. Łazienka | 4,61 m ² |

46,43 m²

PIĘTRO 1

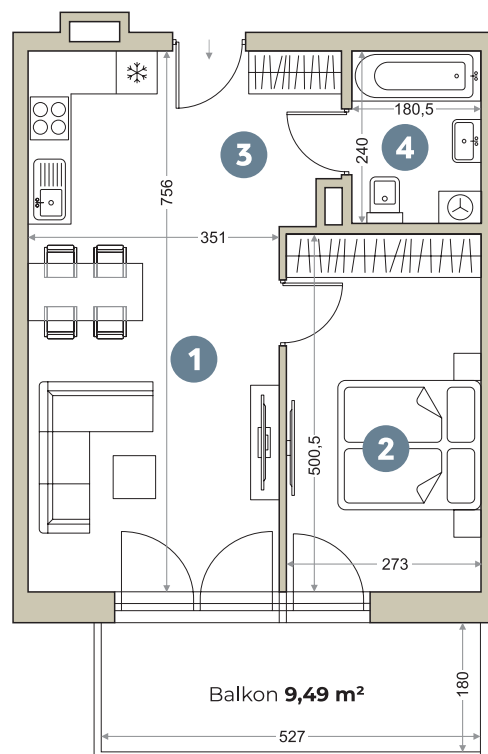



PORTO LAGO

