



# PORTO LAGO

APARTAMENT  
NR 201



Działka Nr 168/1  
Serock



## 63,34 m<sup>2</sup>

CENA

### BUDYNEK 1 KLATKA A

- |                              |                      |
|------------------------------|----------------------|
| 1. Pokój z aneksem kuchennym | 26,30 m <sup>2</sup> |
| 2. Pokój                     | 12,13 m <sup>2</sup> |
| 3. Pokój                     | 13,45 m <sup>2</sup> |
| 4. Hol                       | 4,02 m <sup>2</sup>  |
| 5. Łazienka                  | 7,44 m <sup>2</sup>  |

63,34 m<sup>2</sup>

### PIĘTRO 1

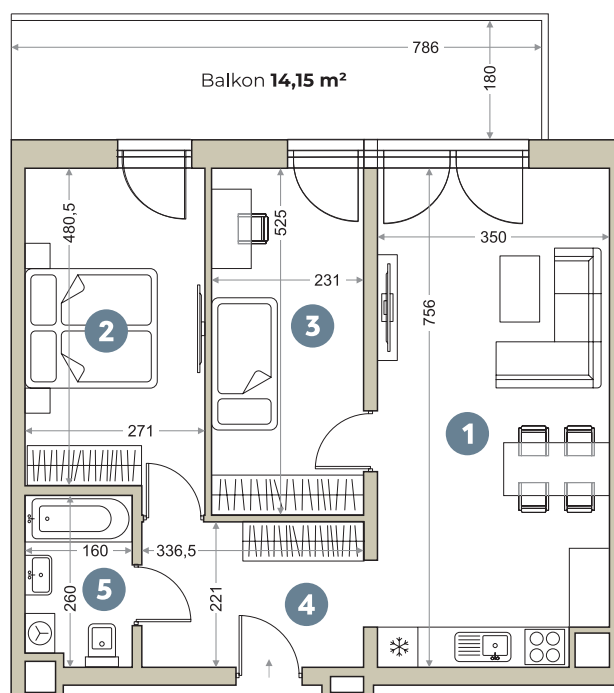



PORTO LAGO

