



# PORTO LAGO

APARTAMENT

NR **312**



Działka Nr 168/1  
Serock

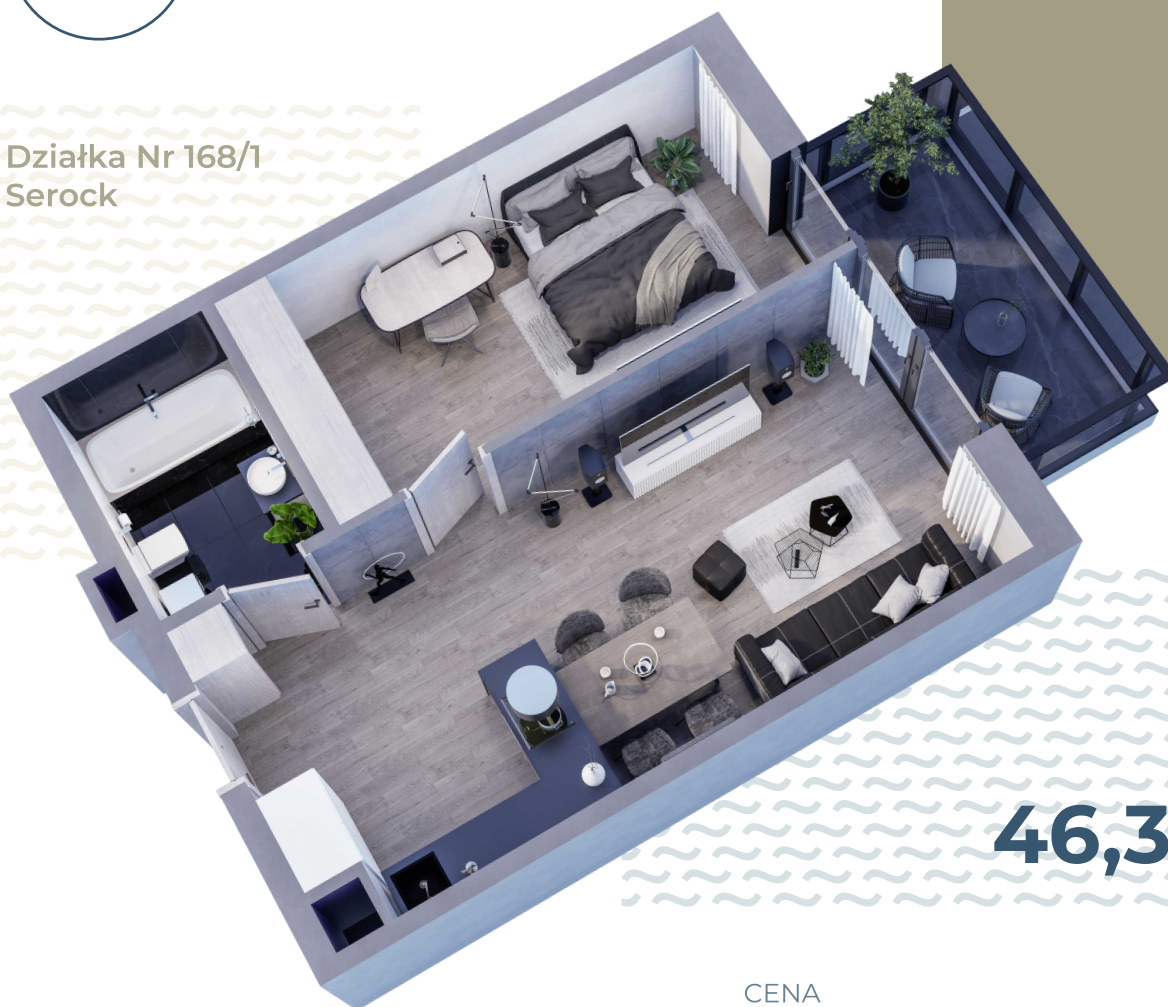

## 46,30 m<sup>2</sup>

### BUDYNEK 1 KLATKA B

- |                              |                            |
|------------------------------|----------------------------|
| 1. Pokój z aneksem kuchennym | <b>23,08 m<sup>2</sup></b> |
| 2. Pokój                     | <b>15,30 m<sup>2</sup></b> |
| 3. Hol                       | <b>3,10 m<sup>2</sup></b>  |
| 4. Łazienka                  | <b>4,82 m<sup>2</sup></b>  |

**46,30 m<sup>2</sup>**

### PIĘTRO 2



### CENA

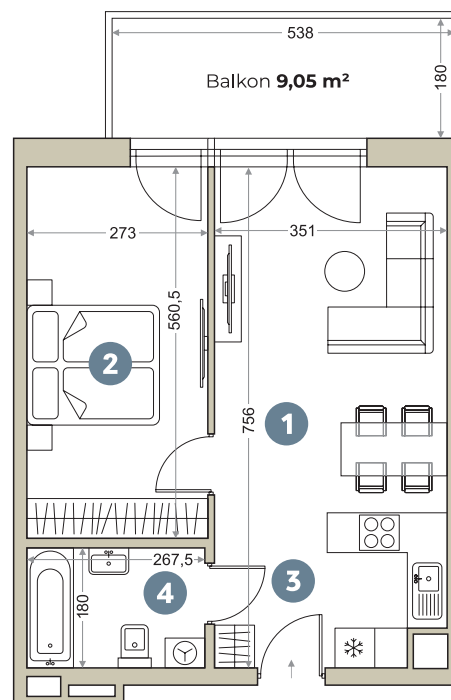



PORTO LAGO

