



# PORTO LAGO

APARTAMENT  
NR 120



Działka Nr 168/1  
Serock

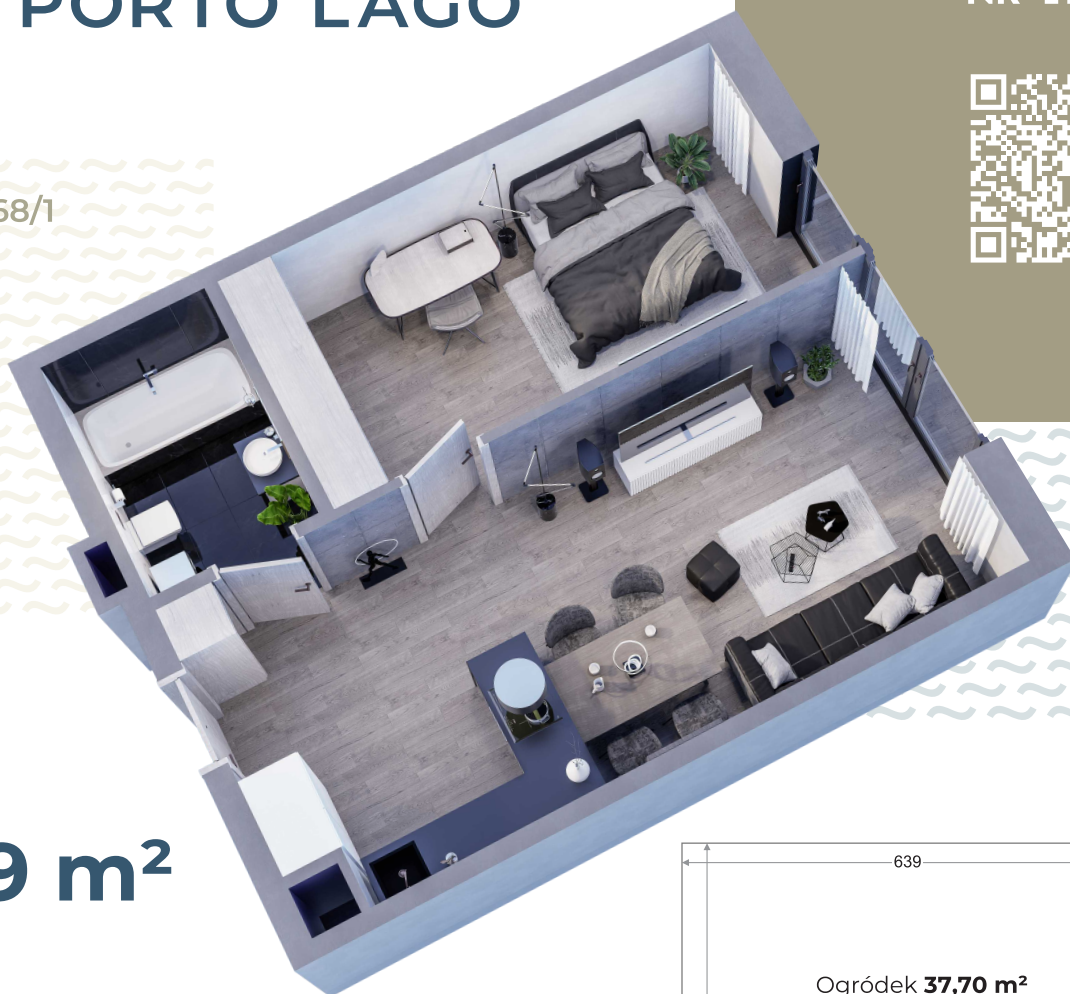

## 46,29 m<sup>2</sup>

CENA

### BUDYNEK 1 KLATKA B

1. Pokój z aneksem kuchennym	23,08 m <sup>2</sup>
2. Pokój	15,30 m <sup>2</sup>
3. Hol	3,09 m <sup>2</sup>
4. Łazienka	4,82 m <sup>2</sup>

46,29 m<sup>2</sup>

### PARTER

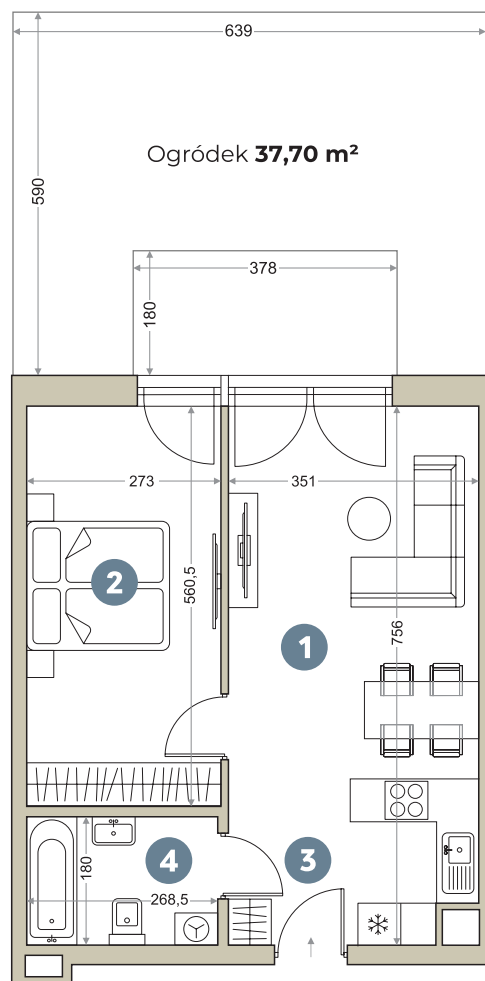



PORTO LAGO

