



PORTO LAGO

APARTAMENT

NR 202



Działka Nr 168/1
Serock

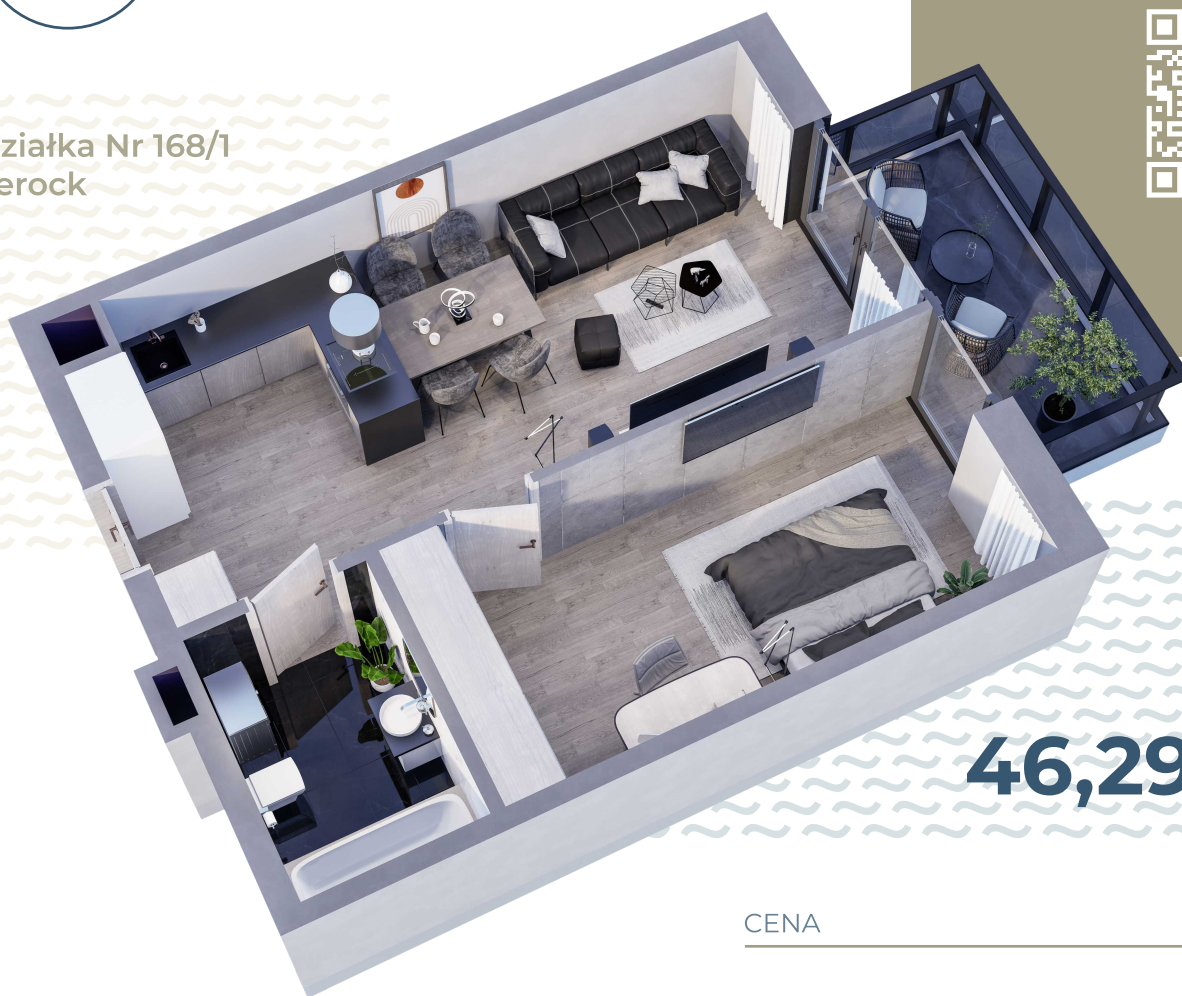

46,29 m²

CENA

BUDYNEK 1 KLATKA A

- | | |
|------------------------------|----------------------------|
| 1. Pokój z aneksem kuchennym | 23,05 m² |
| 2. Pokój | 15,33 m² |
| 3. Hol | 3,09 m² |
| 4. Łazienka | 4,82 m² |

46,29 m²

PIĘTRO 1

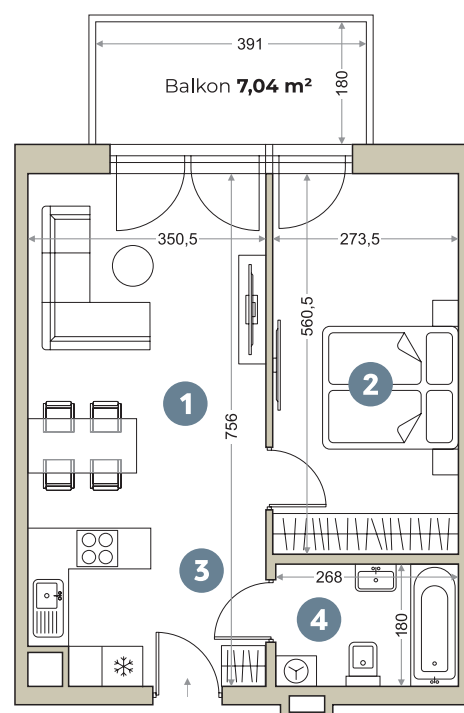



PORTO LAGO

