



PORTO LAGO

APARTAMENT

NR **111**



Działka Nr 168/1
Serock

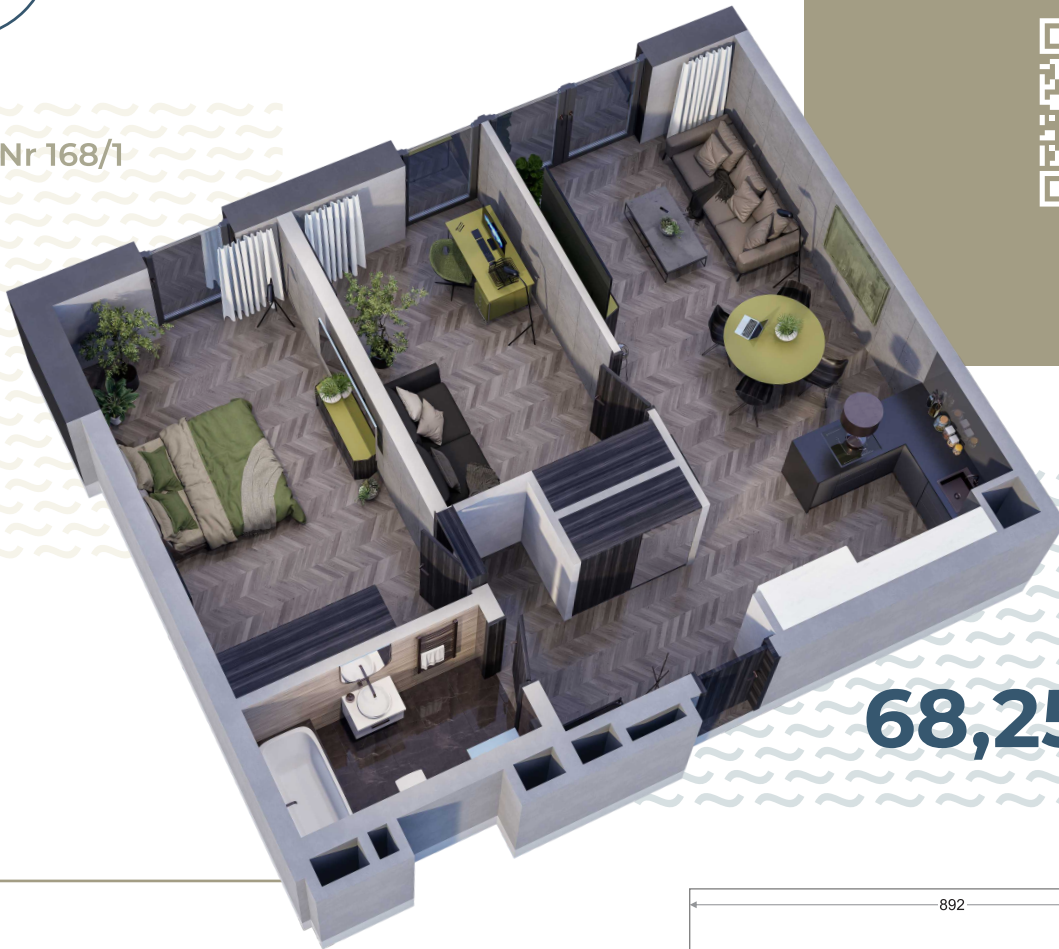

68,25 m²

CENA

BUDYNEK 1 KLATKA B

- | | |
|------------------------------|----------------------------|
| 1. Pokój z aneksem kuchennym | 26,29 m² |
| 2. Pokój | 16,82 m² |
| 3. Pokój | 13,23 m² |
| 4. Hol | 7,02 m² |
| 5. Łazienka | 4,89 m² |

68,25 m²

PARTER

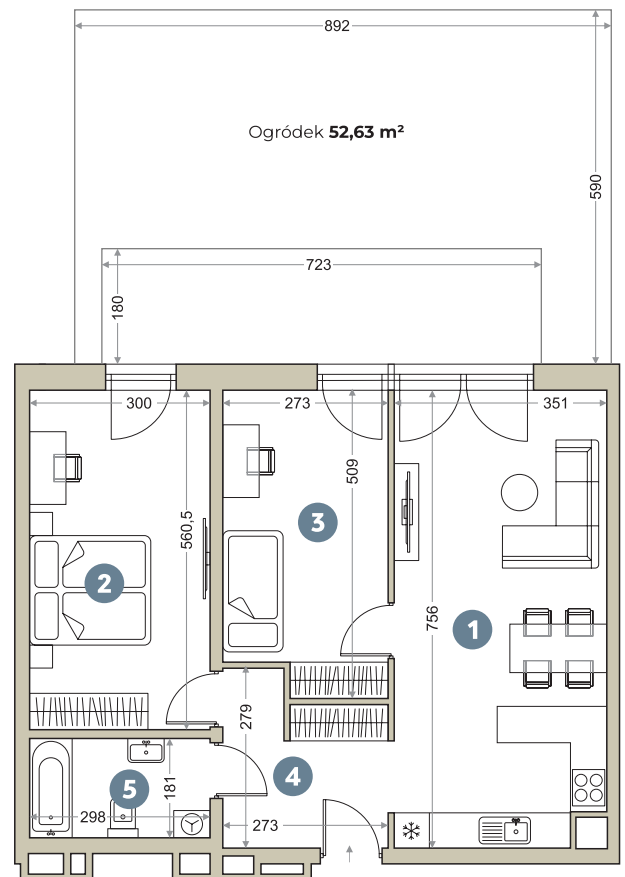



PORTO LAGO

