



# PORTO LAGO

APARTAMENT  
NR **309**



Działka Nr 168/1  
Serock



## 64,37 m<sup>2</sup>

CENA

### BUDYNEK 1 KLATKA A

- |                              |                            |
|------------------------------|----------------------------|
| 1. Pokój z aneksem kuchennym | <b>26,70 m<sup>2</sup></b> |
| 2. Pokój                     | <b>15,18 m<sup>2</sup></b> |
| 3. Pokój                     | <b>12,26 m<sup>2</sup></b> |
| 4. Hol                       | <b>5,53 m<sup>2</sup></b>  |
| 5. Łazienka                  | <b>4,70 m<sup>2</sup></b>  |

**64,37 m<sup>2</sup>**

### PIĘTRO 2

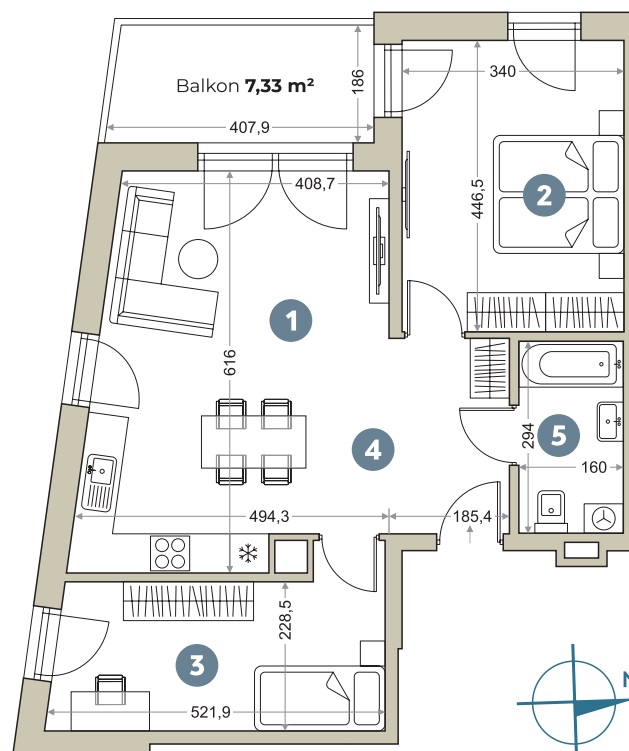



PORTO LAGO

