



PORTO LAGO

APARTAMENT
NR 320



Działka Nr 168/1
Serock

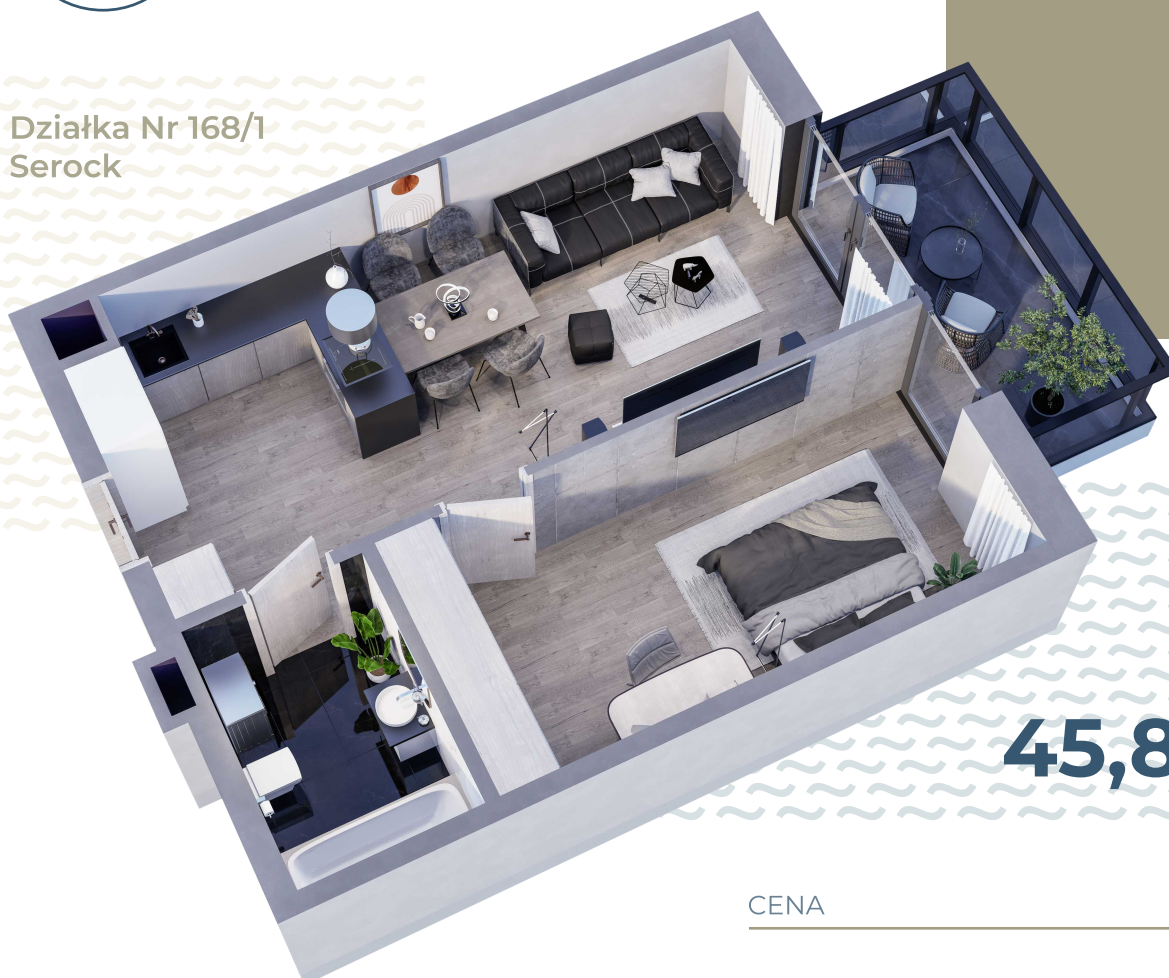

45,85 m²

CENA

BUDYNEK 1 KLATKA B

- | | |
|------------------------------|----------------------|
| 1. Pokój z aneksem kuchennym | 23,08 m ² |
| 2. Pokój | 14,86 m ² |
| 3. Hol | 3,09 m ² |
| 4. Łazienka | 4,82 m ² |

45,85 m²

PIĘTRO 2

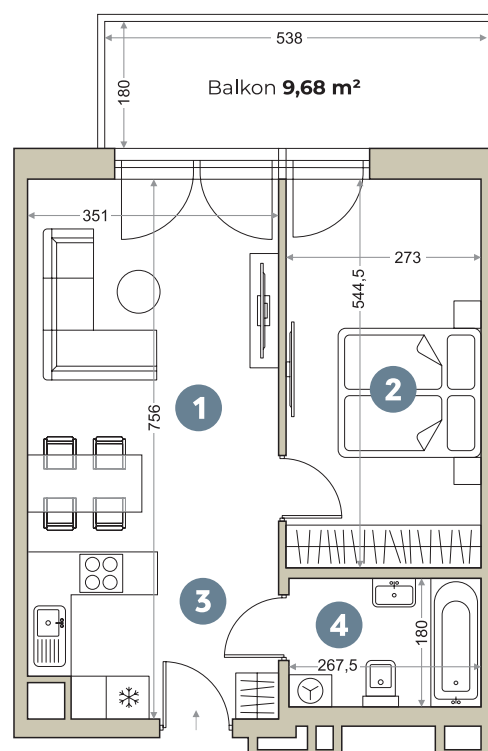



PORTO LAGO

