



PORTO LAGO

APARTAMENT
NR **317**



Działka Nr 168/1
Serock

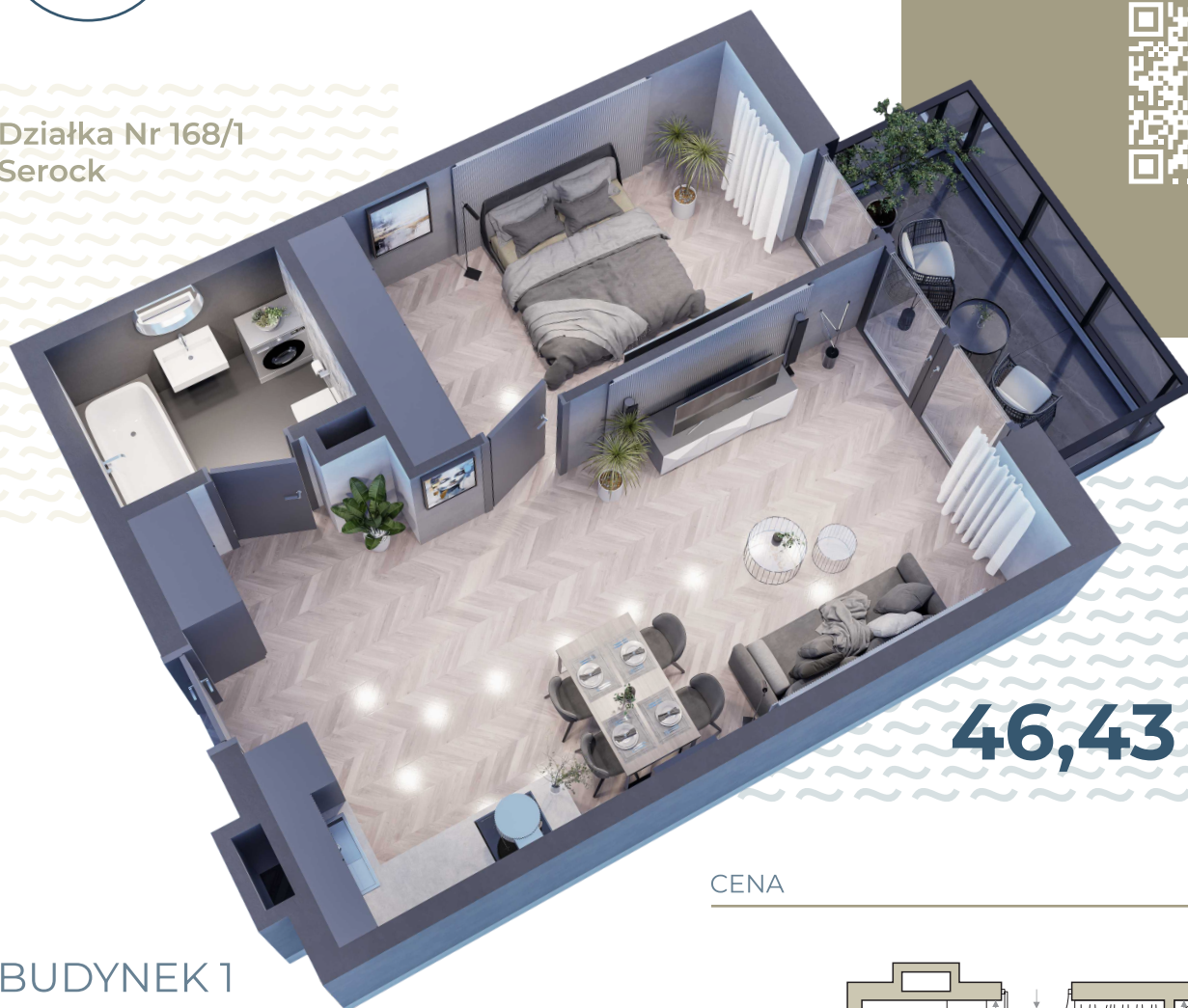

46,43 m²

CENA

BUDYNEK 1 KLATKA B

- | | |
|------------------------------|----------------------------|
| 1. Pokój z aneksem kuchennym | 23,83 m² |
| 2. Pokój | 13,66 m² |
| 3. Hol | 4,33 m² |
| 4. Łazienka | 4,61 m² |

46,43 m²

PIĘTRO 2

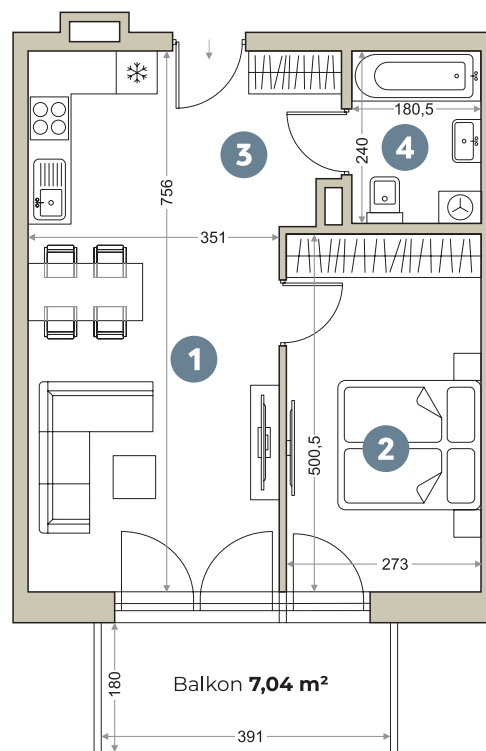



PORTO LAGO

