



PORTO LAGO

APARTAMENT

NR 212



Działka Nr 168/1
Serock

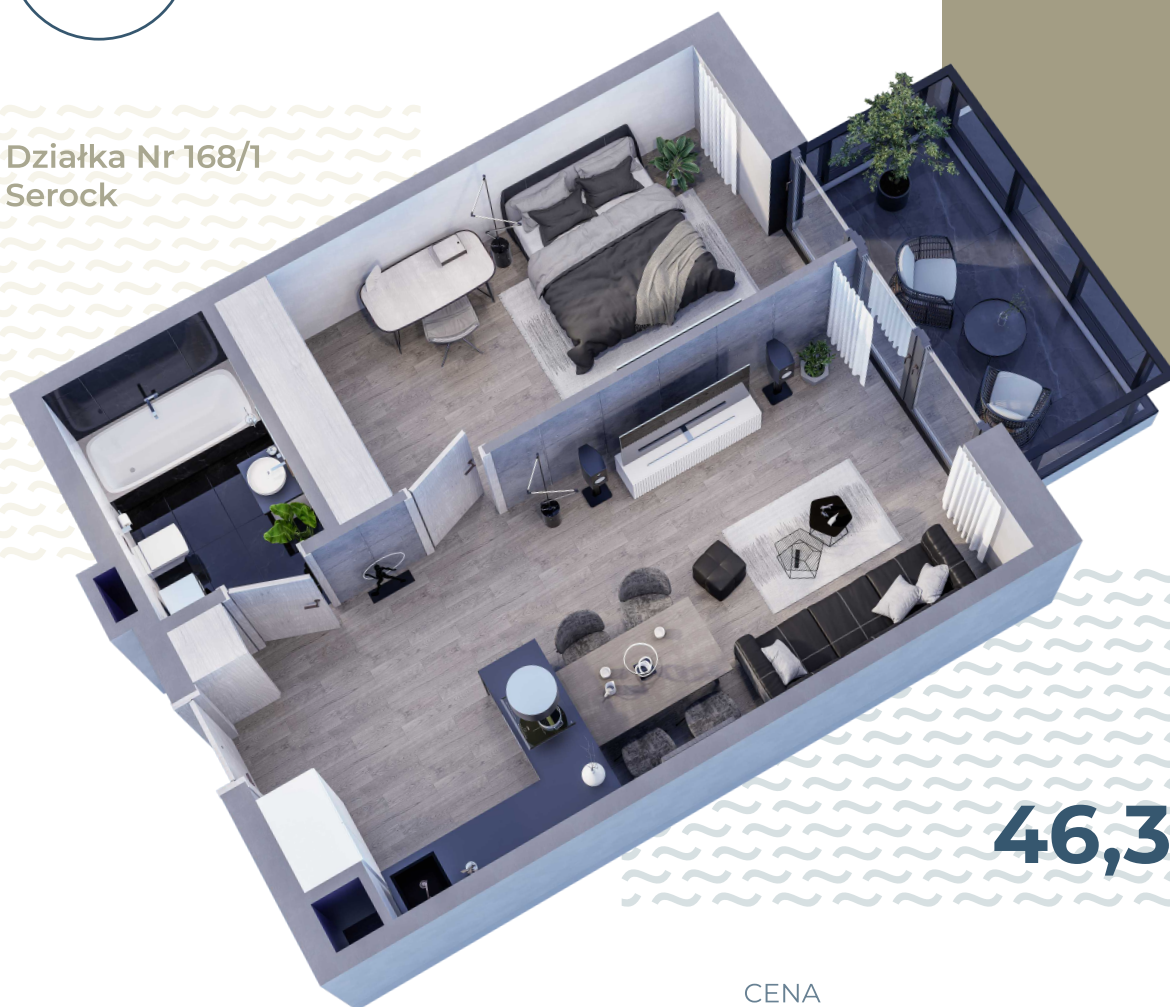

46,30 m²

BUDYNEK 1 KLATKA B

- | | |
|------------------------------|----------------------------|
| 1. Pokój z aneksem kuchennym | 23,08 m² |
| 2. Pokój | 15,30 m² |
| 3. Hol | 3,10 m² |
| 4. Łazienka | 4,82 m² |

46,30 m²

PIĘTRO 1



CENA

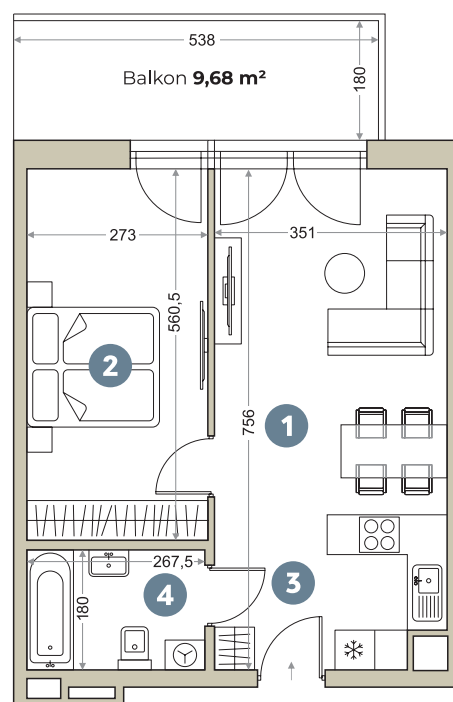



PORTO LAGO

